

**CNB 88**

PHILIPPE **BRIAND** Ltd

JUNE 2021



CNB 88

PHILIPPE BRIAND LTD



CNB 88

PHILIPPE **BRIAND** Ltd



CNB 88

PHILIPPE BRIAND LTD



CNB 88

PHILIPPE BRIAND LTD



CNB 88

PHILIPPE BRIAND Ltd



CNB 88

PHILIPPE **BRIAND** Ltd



CNB 88

PHILIPPE BRIAND Ltd





CNB 88

PHILIPPE BRIAND Ltd



CNB 88

PHILIPPE BRIAND Ltd



CNB 88

PHILIPPE BRIAND Ltd

Teak winch base



CNB 88

PHILIPPE BRIAND Ltd



CNB 88

PHILIPPE BRIAND LTD

Teak winch base



CNB 88

PHILIPPE BRIAND LTD



CNB 88

PHILIPPE BRIAND Ltd



CNB 88

PHILIPPE BRIAND Ltd





CNB 88

PHILIPPE BRIAND Ltd



CNB 88

PHILIPPE BRIAND Ltd



CNB 88

PHILIPPE BRIAND Ltd



CNB 88

PHILIPPE BRIAND Ltd



CNB 88

PHILIPPE BRIAND Ltd



CNB 88

PHILIPPE BRIAND LTD

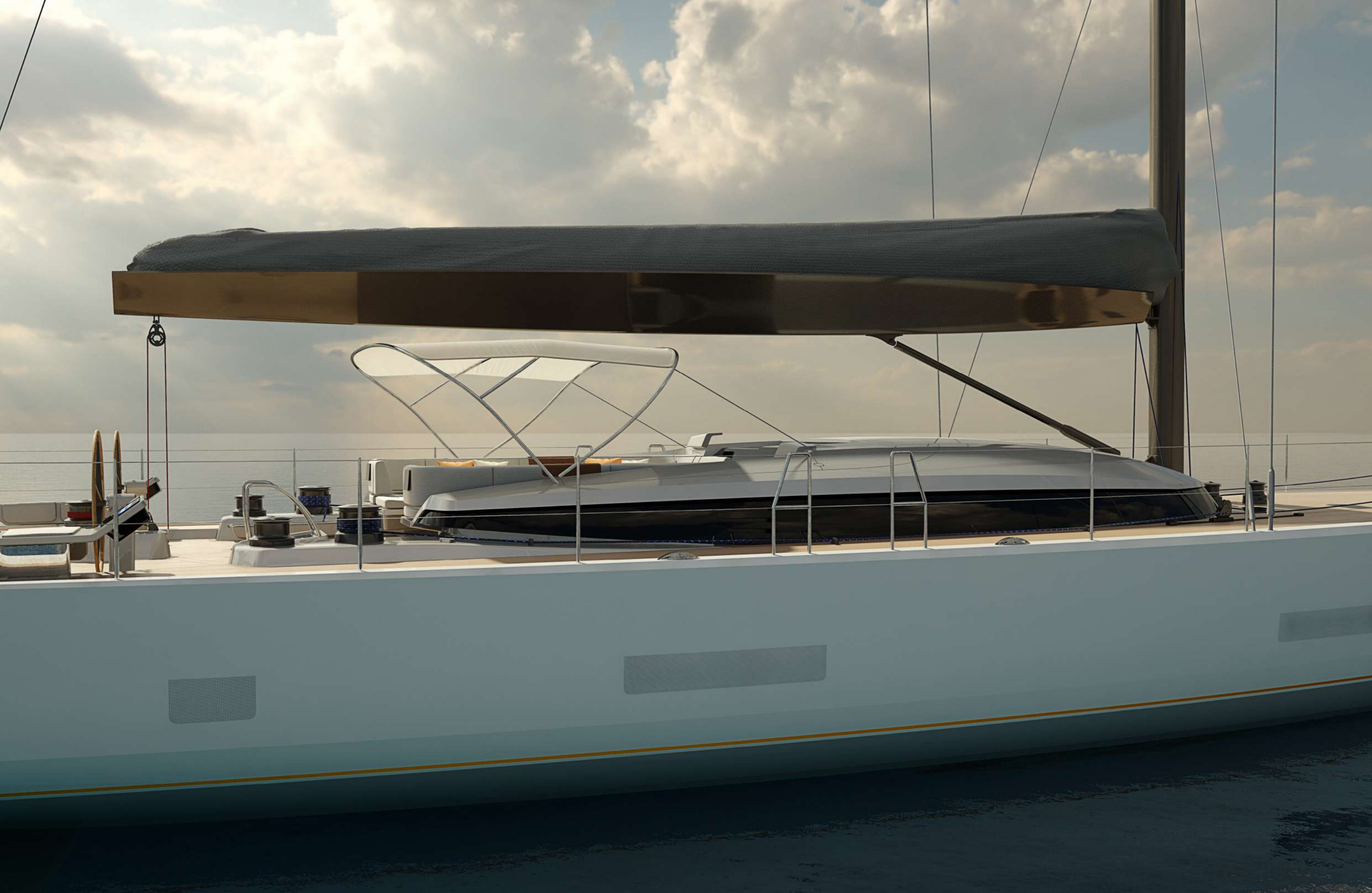

CNB 88

PHILIPPE BRIAND Ltd



CNB 88

PHILIPPE BRIAND Ltd



# General Arrangement VI

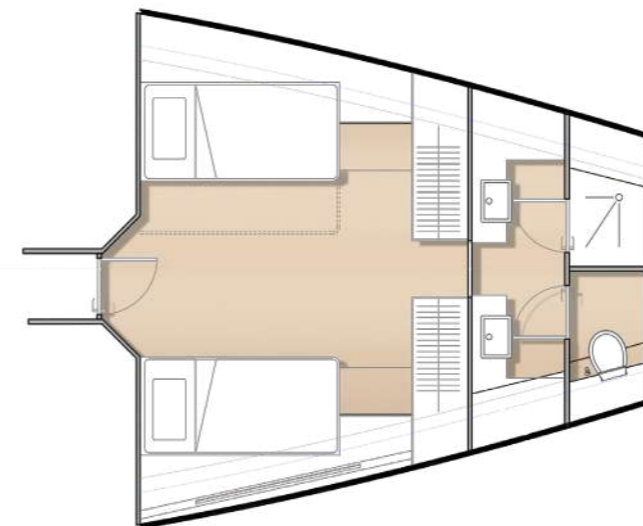
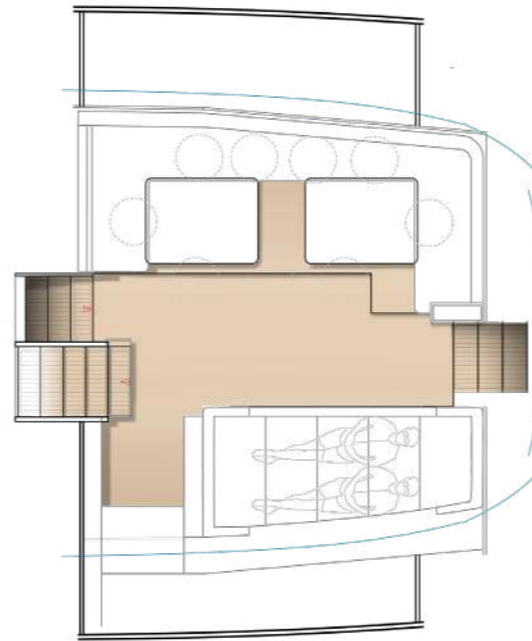

# General Arrangement V2

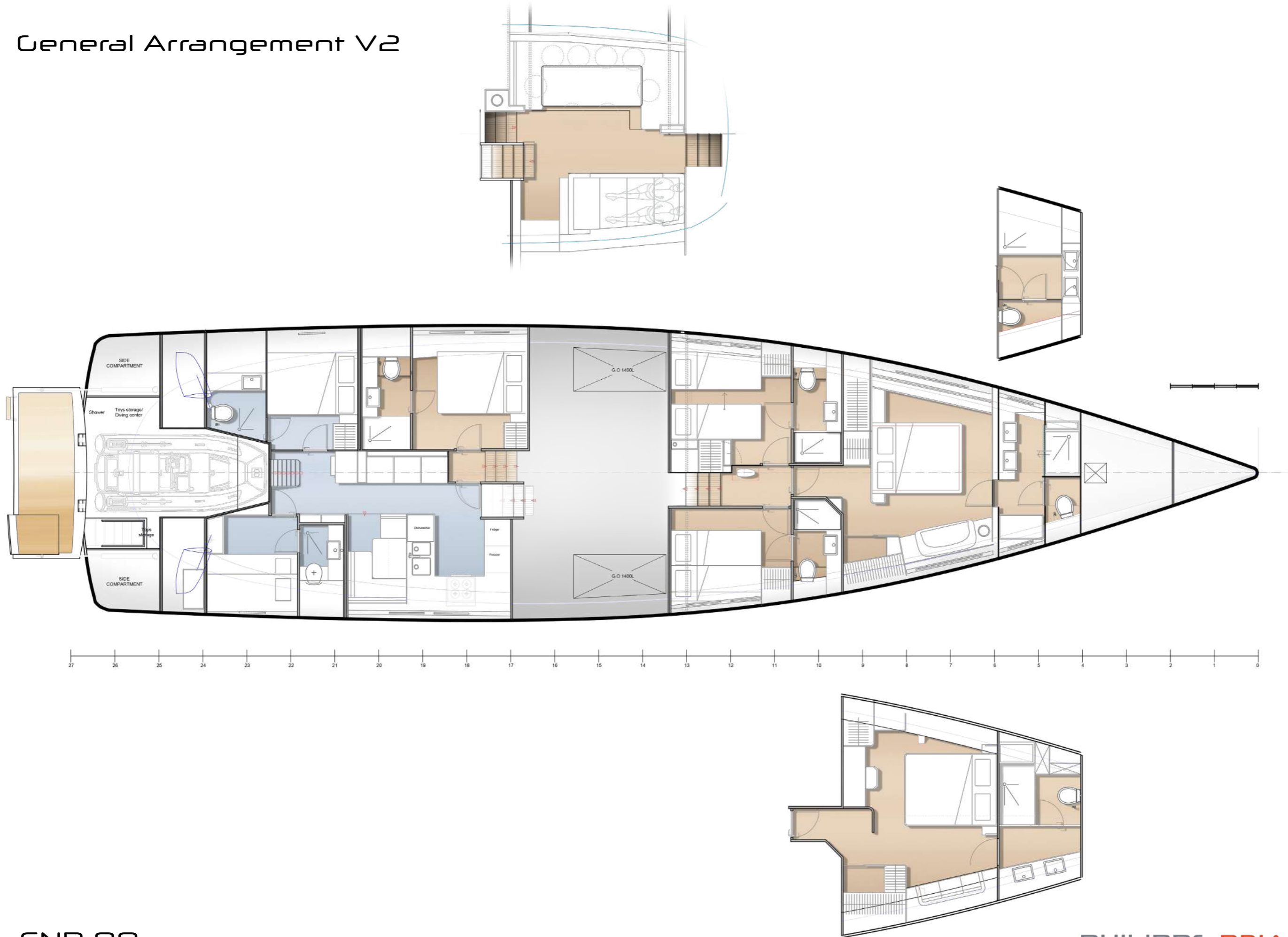

# Sailplan

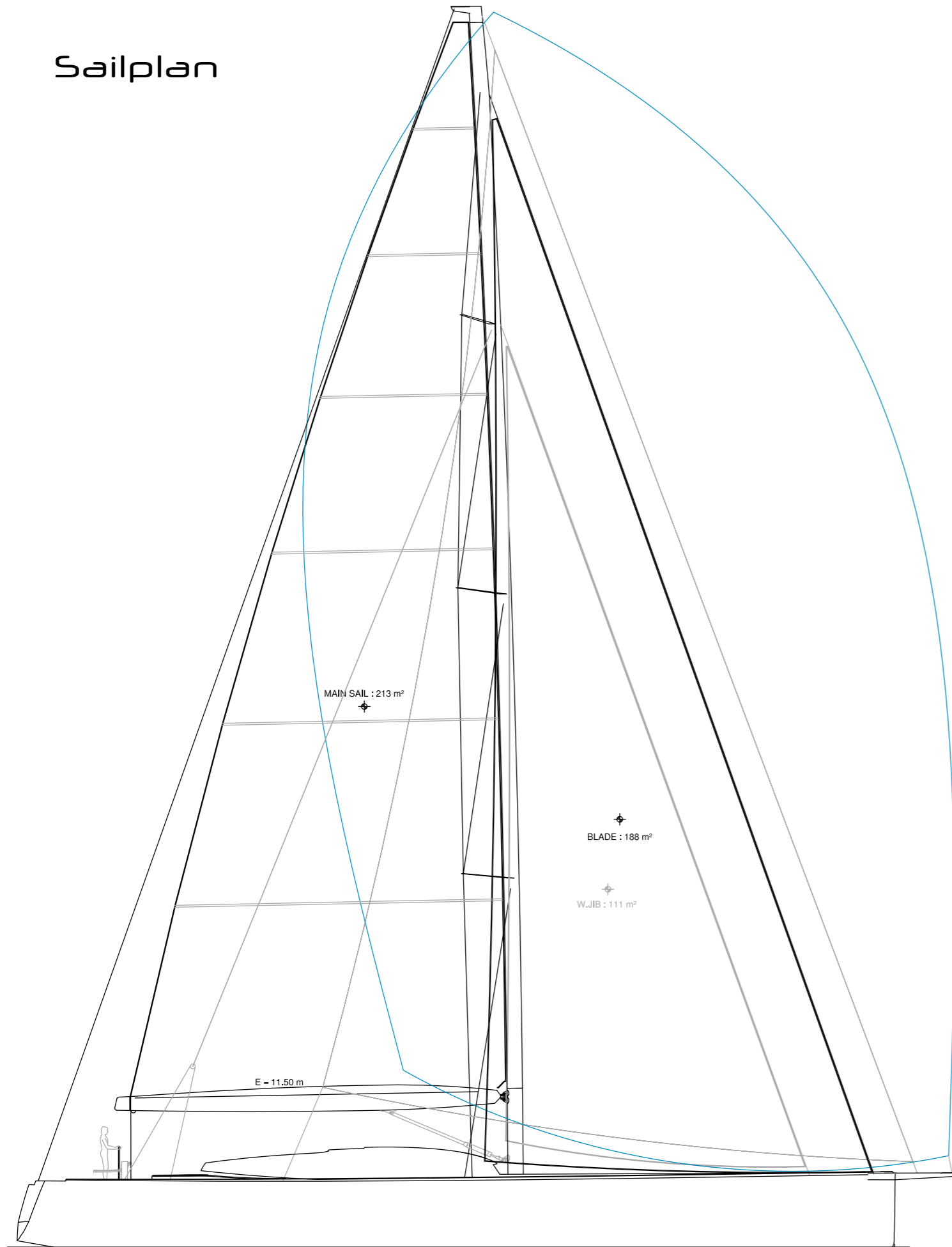

# Preliminary Specifications

## DIMENSIONS

Length overall : 28,3 m (bowsprit included)  
 Hull Length : 26,8 m  
 L.W.L : 24,7 m  
 Maximum beam : 6,75 m

## DRAFTS

Standard keel (cast iron fin & lead bulb), 3.75 m  
 Optional keel (steel fin & lead bulb), 3.25 m

## TANKAGE

Fresh water capacity: 1,800 litres  
 Fuel capacity: 3,000 litres

## SAILS AREAS (sails not supplied)

	Standard Sail Plan	Performance Sail Plan
Mainsail	213 m <sup>2</sup>	228 m <sup>2</sup>
Furling genoa	188 m <sup>2</sup>	199 m <sup>2</sup>
Staysail	111 m <sup>2</sup>	118 m <sup>2</sup>
Asymmetrical spinnaker	580 m <sup>2</sup>	595 m <sup>2</sup>

## AIR DRAFT (Without Antennas)

Standard Sail Plan	37,9 m
Performance Sail Plan - Carbon	40,0 m

## DESIGN

Naval architecture Philippe BRIAND  
 Interior design PIATON BERCAULT & CO

**PHILIPPE BRIAND Ltd**

53 Stewarts Grove  
Chelsea  
London UK SW3 6PH

e : [yachts@philippebriand.com](mailto:yachts@philippebriand.com)

[www.philippebriand.com](http://www.philippebriand.com)